

PROFILE
Scale: Horiz. 1"=20'
Vert. 1"=2'



TYPICAL X-SECTION
Scale: Horiz. 1"=10'
Vert. 1"=1'

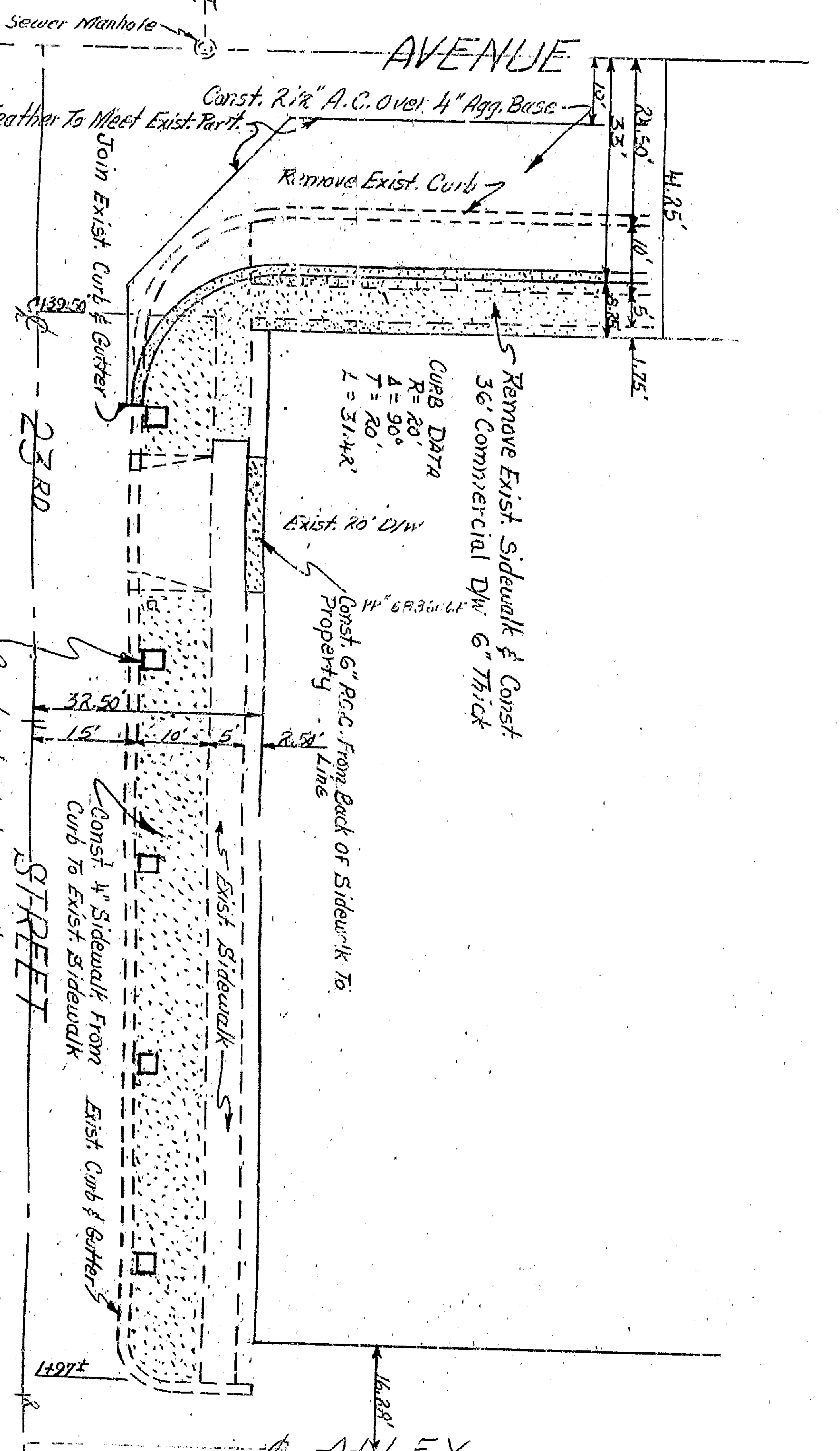
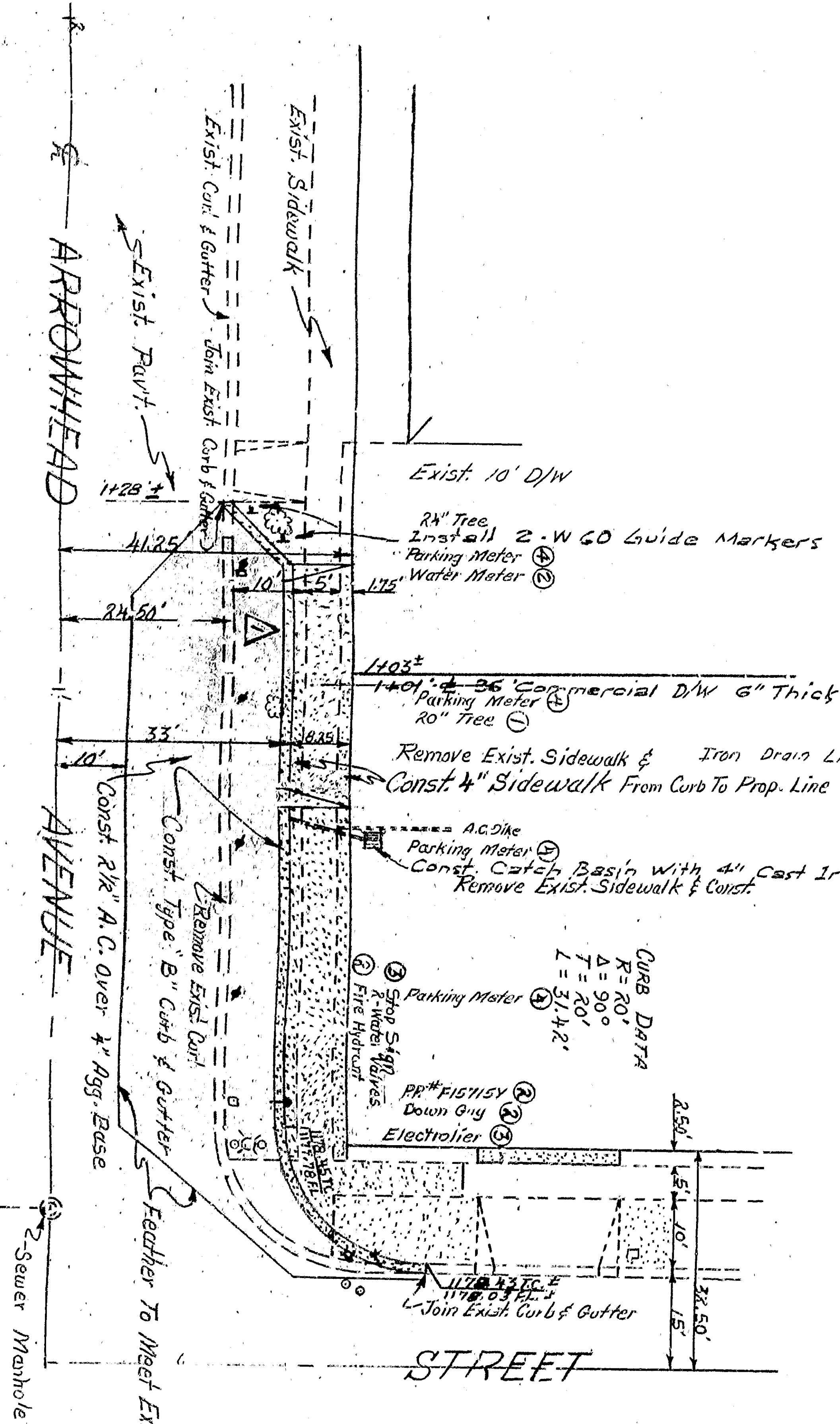
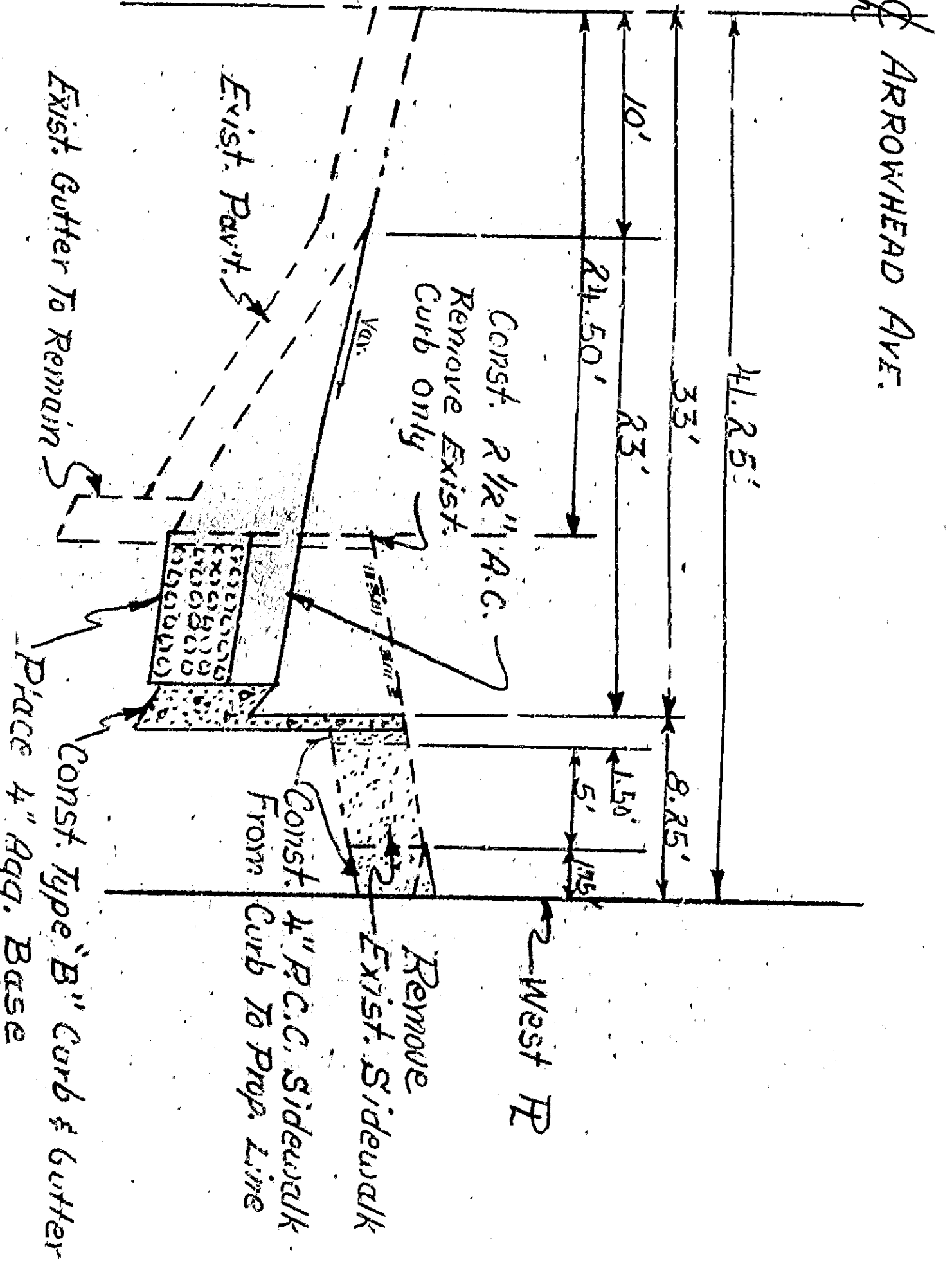

GENERAL NOTES

- All work embodied on this plan shall be done in conformity with applicable provisions of Standard Specifications No. R271, Revised October 1966, on file in the Office of the City Engineer.
- Obstructions (smokestacks, etc.) shall be removed under this contract.
- To be removed or relocated by others.
- To be removed & relocated under this contract (Flagging on Street Signs shall be Class "B" Concrete same as original installation.)
- Parking Meter Post are to be removed & taken to the City Yards.

APPROVED	DESIGNED	CHECKED	DATE
[Signature]	[Signature]	[Signature]	11/1/66
CITY ENGINEER	CITY ENGINEER	CITY ENGINEER	
REGISTERED CIVIL ENGINEER NO. 12653	REGISTERED CIVIL ENGINEER NO. 12653	REGISTERED CIVIL ENGINEER NO. 12653	
DEPARTMENT OF ENGINEERING			
CITY OF SAN BERNARDINO			
IMPROVEMENT PLANS			
S/W CORNER 23RD ST & ARROWHEAD AVE.			
SHEET 1 OF 1			

PROFILE
Scale: Horiz. 1"=20'
Vert. 1"=2'



TYPICAL X-SECTION
Scale: Horiz. 1"=10'
Vert. 1"=1'

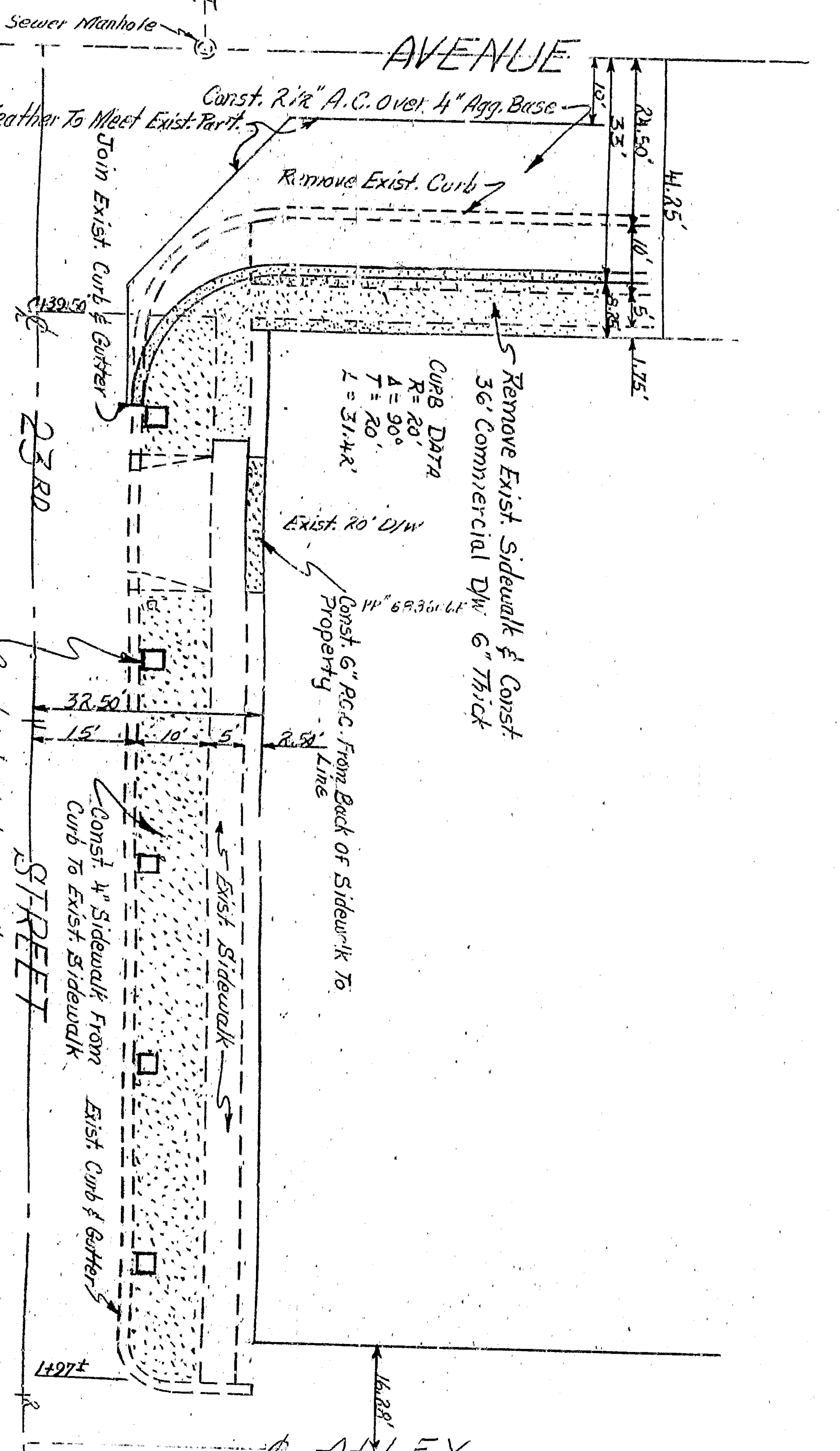
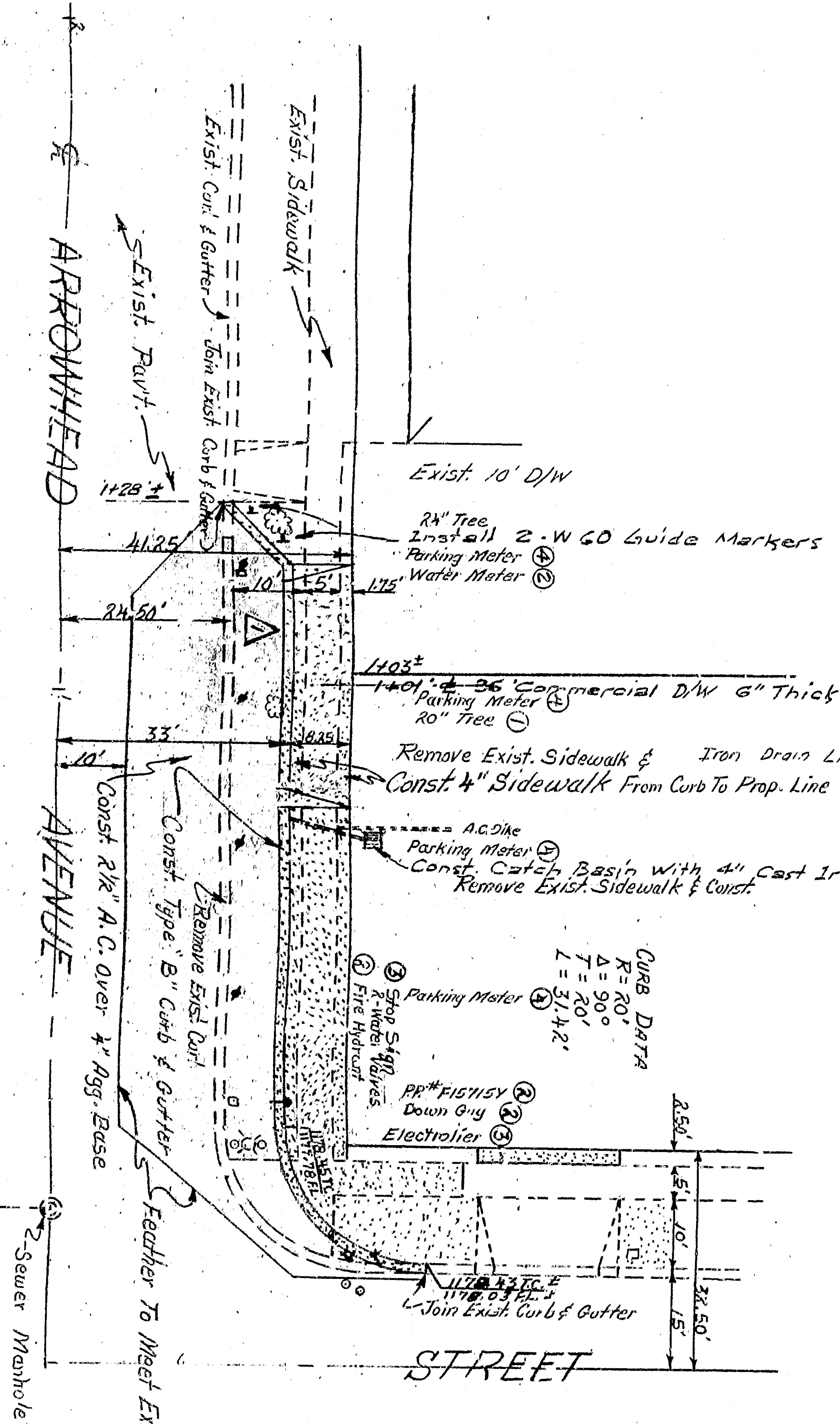
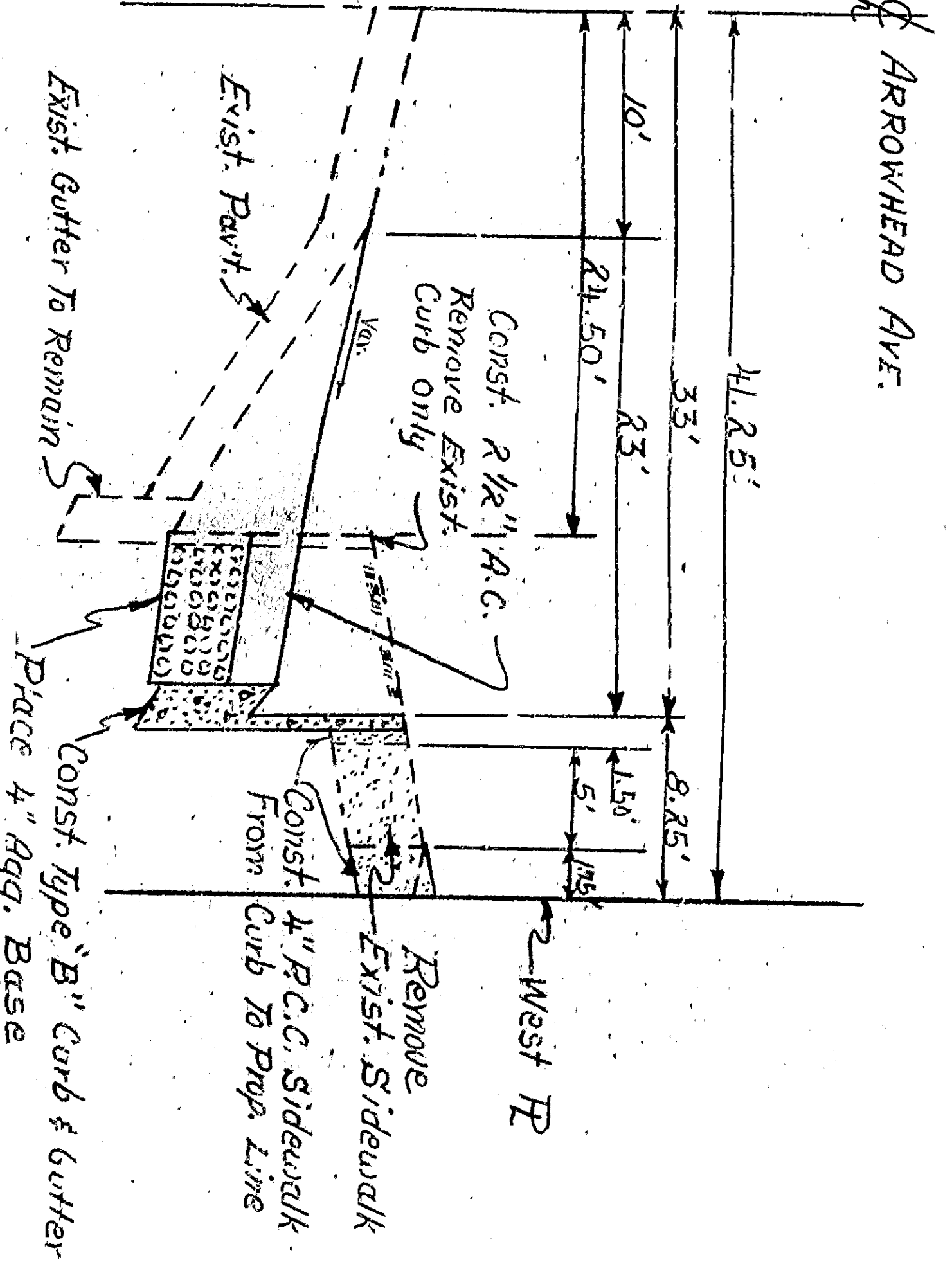

GENERAL NOTES

1. All work embodied on this plan shall be done in conformity with applicable provisions of Standard Specifications No. R271, Revised October 1966, on file in the Office of the City Engineer.
2. Obstructions (smokestacks, etc.)
 1. To be removed under this contract.
 2. To be removed or relocated by others.
 3. To be removed & relocated under this contract (Flagging on Street Signs shall be Class "B" Concrete same as original installation.)
 4. Parking Meter Post are to be removed & taken to the City Yards.

Scale: 1"=20'

23.00

Scale: 1"=20'

APPROVED	DESIGNED	CHECKED	DATE
<i>[Signature]</i>	<i>[Signature]</i>	<i>[Signature]</i>	10/1/66
CITY ENGINEER	CITY ENGINEER	CITY ENGINEER	
REGISTERED CIVIL ENGINEER NO. 12653	REGISTERED CIVIL ENGINEER NO. 12653	REGISTERED CIVIL ENGINEER NO. 12653	
DEPARTMENT OF ENGINEERING			
CITY OF SAN BERNARDINO			
IMPROVEMENT PLANS			
S/W CORNER 23RD ST & ARROWHEAD AVE.			
SHEET 1 OF 1 SHEETS			